

# Quick Start Guide: Setting up your WiFi and App

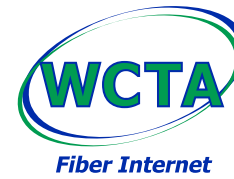

www.wctatel.net  
800-592-6105  
704 E Main St, Lake Mills, IA 50450

1 Download the app. You can search either the Apple App Store or Google Play Store for: **“WCTA Managed WiFi”**, then install it on your mobile device.



2 Select “SIGN UP” towards the bottom of the screen.

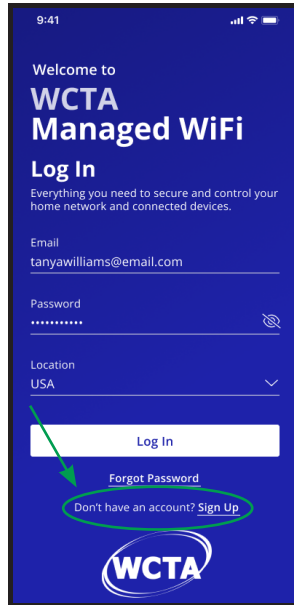

3 Enter your personal information. The password you enter here will be used to access the app.

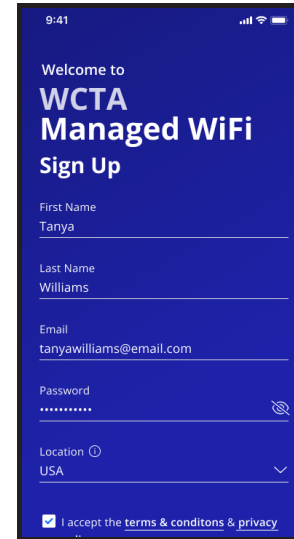

**Note:**  
Please wait at least 10 minutes after your GigaSpire BLAST System has been “turned up” before attempting step 4.

4 Select “Yes” to continue.

5 Tap the QR code that appears within the app. (You will be asked to allow the app to access your camera). Point your camera at the QR Code found on the bottom of your GigaSpire BLAST System, or on the sticker that came in your box (example shown below). Select OK.

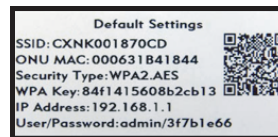

6 **Note:**  
Since your system is already operating with WiFi, select the “Skip this step” option and the “I don’t have a mesh (SAT)” option.

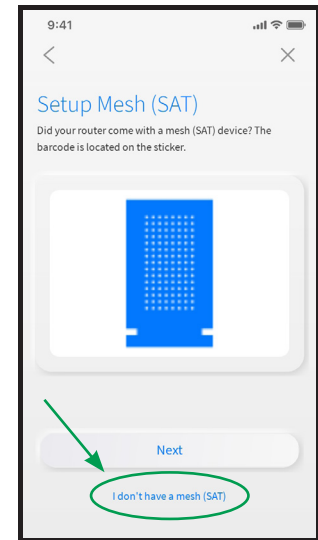
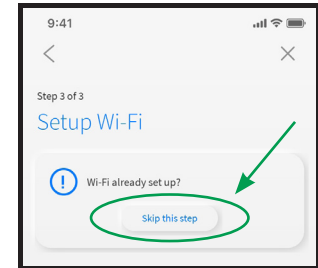

## Getting started with the App

The App allows you to manage your home or small business WiFi network. You can self-install and be managing your home or business within a few minutes. Download the app and start managing your home network today!

### Next:

Refer to the **WCTA Managed WiFi Consumer Product Guide** for details on how to use specific features.

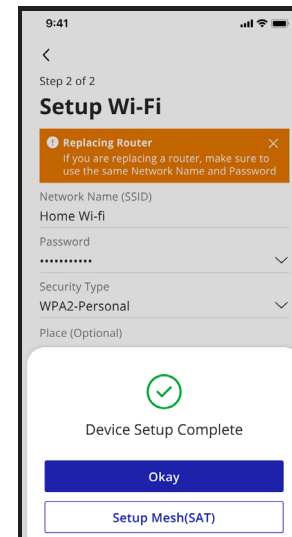
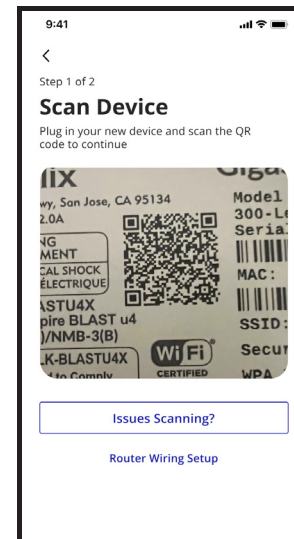

**Click “Okay”  
and you’re  
all done!**

## Need help?

Contact support: www.wctatel.net | 800-592-6105 | 24 HR TECHNICAL SUPPORT: 877-928-2835

	<b>WCTA Managed WiFi (Free Mobile App)</b>	<b>Adding Security Plus to WCTA Managed WiFi for \$6.95 Per Month</b>
<b>Add Guest Network</b>	✓	✓
<b>View Connected Device Information</b>	✓	✓
<b>Basic Parental Control</b>	✓	✓
<b>Create profiles</b>	✓	✓
<b>Name and add an image for profile</b>	✓	✓
<b>Add/remove devices to each profile</b>	✓	✓
<b>Manually turn a profile off or on</b>	✓	✓
<b>Schedule offline times</b>	✓	✓
<b>View Network Map</b>	✓	✓
<b>Reset SSID and Password</b>	✓	✓
<b>View Network Usage</b>	✓	✓
<b>Conduct Speed Tests</b>	✓	✓
<b>QoS – prioritize traffic by type (Work From Home, streaming, gaming, etc.)</b>		✓
<b>Filter content by category</b>		✓
<b>Filter content by application</b>		✓
<b>Filter content by website</b>		✓
<b>View approximate usage per profile</b>		✓
<b>Add time limit to application per day</b>		✓
<b>Enable/disable Safe Search</b>		✓
<b>Enable/disable YouTube Restriction</b>		✓
<b>Content filter VPN/Proxy</b>		✓
<b>Continually scan for and protect against viruses and malicious content</b>		✓
<b>Protect connected devices at the router level – not just individual endpoints</b>		✓
<b>Receive virus and intrusion block notifications</b>		✓
<b>Customize protection level for entire network, per profile, or per device</b>		✓